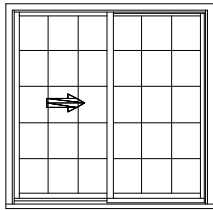
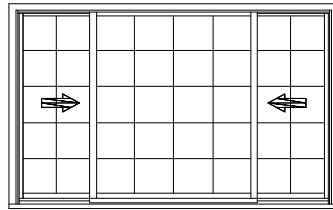

TABLE OF CONTENTS

Elevations/Sizes: 1/4" Scale	8-2
2-Panel Windows	8-4
3-Panel Windows	8-5
Sash Glazing Options: 3" Scale	8-6
Trim Options: 3" Scale	8-7
Jamb Extender Options: 3" Scale	8-8
Standard Mullion Options	8-9
Lite Cut Information & Options	8-10
Unit Sizing, Rough Openings & Masonry Openings	8-12
Section Details: 6" Scale	8-13

GENERAL INFORMATION



OPERATING UNIT
(LEFT SHOWN)



OPERATING UNIT
(LEFT/STATIONARY/RIGHT)

DIMENSIONAL WINDOWS

Wood horizontal sliding windows may be specified as "dimensional", by adjusting the desired rough opening width or height in 1/8" increments from standard.

Wood horizontal sliding windows are available in standard and triple unit styles. Standard units feature one operating sash and one fixed sash. Triple unit styles feature a fixed center sash with operating sash on both sides. Operating sash are easily removable for cleaning. Units are supplied with dual cam-type sash locks installed. There are several hardware finish options available. Refer to the specifications for finish options.

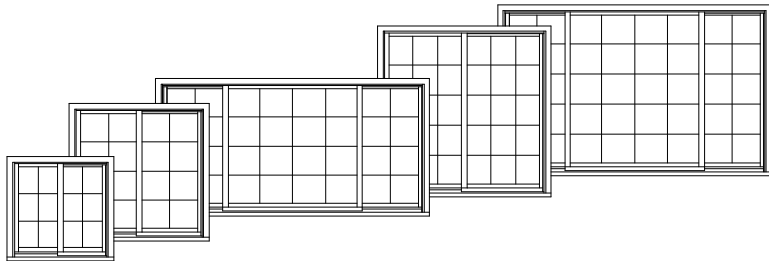

MULTIPLE ASSEMBLIES

Wood horizontal sliding windows may be mulled side-by-side to fill larger openings. Factory assembled mulls are limited to a maximum of two basic units, not to exceed 40 square feet in total area. Larger assemblies may be field mulled.

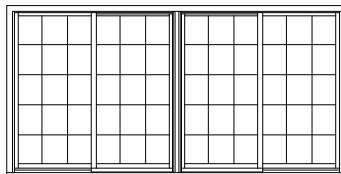

ELEVATION NOTES

ELEVATION DRAWINGS UTILIZE A LIMITED NUMBER OF PROJECTED LINES TO PRODUCE A RUDIMENTARY DRAWING INTENDED TO BE USED IN A SMALL GRAPHICAL SCALE. ELEVATIONS ARE VIEWED PERPENDICULAR FROM THE EXTERIOR OF THE STRUCTURE. IF MORE DIMENSIONS ARE NEEDED, USE THE SECTION DRAWINGS FOR MORE COMPLETE DEPICTIONS.

M.O. Brickmould	37 11/16" (957)	Masonry Openings for Brickmould, Flat & Adams Casing. Vertical measurements include sillnose. (Subtract 1/2" from Masonry Opening for Unit Size)
M.O. Adams/Flat Casing	40 11/16" (1033)	
Rough Opening	36 1/4" (921)	
Frame Size	35 1/2" (902)	
Daylight Opening	14 1/2" (368)[2]	

- 25 11/16" (652)
- 27 3/16" (691)
- 24 1/2" (645)
- 23 3/4" (603)
- 17 1/2" (445)

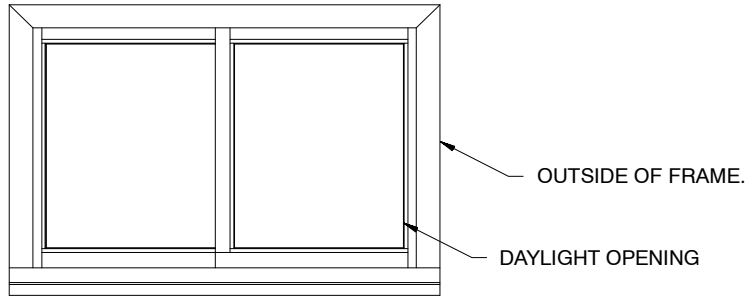

WW1U1-3020

- 'WW1U1' INDICATES TRADITION PLUS WOOD SLIDER
- THE FIRST TWO NUMBERS INDICATE THE UNIT WIDTH
- BOOK CODE
- THE LAST TWO NUMBERS INDICATE THE UNIT HEIGHT

GENERAL HORIZONTAL SLIDING WINDOWS NOTES:

1. UNIT ELEVATIONS ARE SHOWN WITH BRICKMOULD AND SILLNOSE.
2. ALL UNITS ARE AVAILABLE AS OPERATORS ONLY.
3. DIMENSIONAL VALUES IN PARENTHESIS ARE MILLIMETER CONVERSIONS.
4. VALUES IN BRACKETS ARE NUMBER OF DAYLIGHT OPENINGS PER UNIT.

ELEVATION SYMBOL LEGEND:

- MO** MASONRY OPENING
- E** BASIC UNIT CLEAR OPENING EXCEEDS 20" IN WIDTH, 24" IN HEIGHT & A MINIMUM OF 5.7 SQ. FT.

2-PANEL UNITS

M.O. BRICKMOUND
M.O. ADAMS/FLAT CASING
ROUGH OPENING
FRAME SIZE
DAYLIGHT OPENING

37 11/16" (957)
40 11/16" (1033)
36 1/4" (921)
35 1/2" (902)
14 1/2" (368)[2]

49 11/16" (1262)
52 11/16" (1338)
48 1/4" (1226)
47 1/2" (1207)
20 1/2" (521)[2]

61 11/16" (1567)
64 11/16" (1643)
60 1/4" (1530)
59 1/2" (1511)
26 1/2" (673)[2]

73 11/16" (1872)
76 11/16" (1948)
72 1/4" (1835)
71 1/2" (1861)
32 1/2" (826)[2]

25 11/16" (652)
27 3/16" (691)
24 1/2" (622)
23 3/4" (603)
17 1/2" (445)

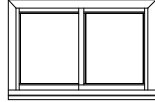

WW1U1-3020

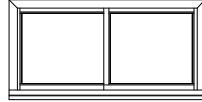

WW1U1-4020

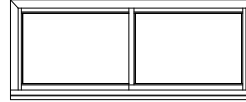

WW1U1-5020

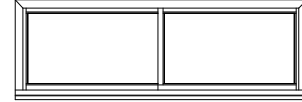

WW1U1-6020

37 11/16" (957)
39 3/16" (995)
36 1/2" (927)
35 3/4" (908)
29 1/2" (749)

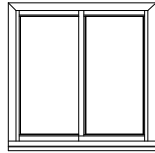

WW1U1-3030

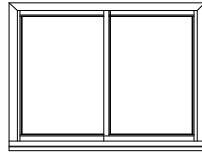

WW1U1-4030

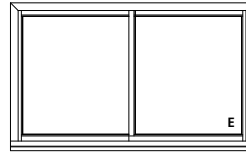

WW1U1-5030

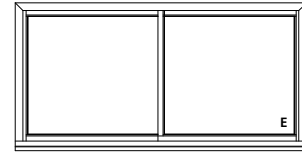

WW1U1-6030

43 11/16" (1110)
45 3/16" (1148)
42 1/2" (1080)
41 3/4" (1060)
35 1/2" (902)

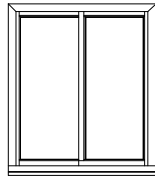

WW1U1-3036

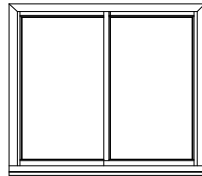

WW1U1-4036

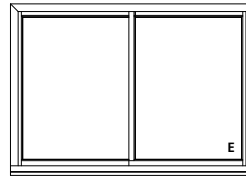

WW1U1-5036

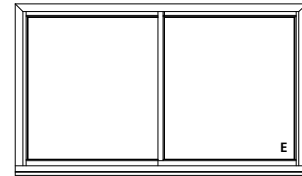

WW1U1-6036

49 11/16" (1262)
51 3/16" (1300)
48 1/2" (1232)
47 3/4" (1213)
41 1/2" (1054)

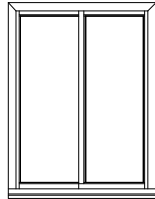

WW1U1-3040

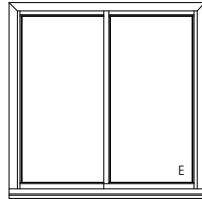

WW1U1-4040

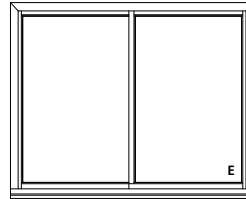

WW1U1-5040

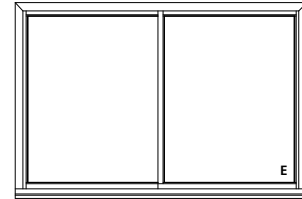

WW1U1-6040

61 11/16" (1567)
63 3/16" (1605)
60 1/2" (1537)
59 3/4" (1518)
53 1/2" (1359)

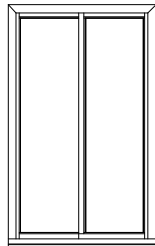

WW1U1-3050

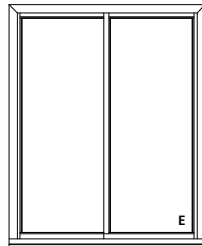

WW1U1-4050

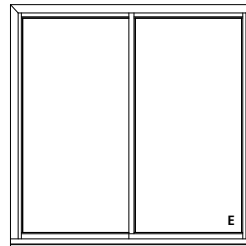

WW1U1-5050

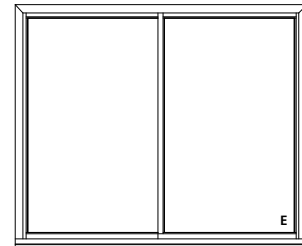

WW1U1-6050

ELEVATION SYMBOL LEGEND:

M.O. = MASONRY OPENING
VALUES IN () ARE IN MILLIMETER CONVERSIONS
VALUES IN [] ARE NUMBER OF DAYLIGHT OPENINGS PER UNIT
E BASIC UNIT CLEAR OPENING EXCEEDS 20" IN WIDTH, 24" IN HEIGHT & A MINIMUM OF 5.7 SQ. FT.

Note Elevations shown DO NOT have exterior trim. Subtract 3/4" (19) from M.O. (Masonry Opening) for Unit Sizes. Masonry Openings above include Sill Nose, see Trim Options page for Sill Nose specifications. For other Trim Options refer to the Unit Sizing, Rough Opening & Masonry Openings page.

SCALE: 1/4" = 1'

3-PANEL UNITS

M.O. BRICKMOULD	85 11/16" (2176)	97 11/16" (2481)
M.O. ADAMS/FLAT CASING	88 11/16" (2253)	100 11/16" (2557)
ROUGH OPENING	84 1/4" (2140)	96 1/4" (2445)
FRAME SIZE	83 1/2" (2121)	95 1/2" (2426)
DAYLIGHT OPENING	20 1/2" (521) [2] 34 1/4" (870)	20 1/2" (521) [2] 46 1/4" (1175)

43 11/16" (1110) 45 3/16" (1148) 42 1/2" (1080) 41 3/4" (1060) 35 1/2" (902)		
	WW1U1-7036	WW1U1-8036
49 11/16" (1262) 51 3/16" (1300) 48 1/2" (1232) 47 3/4" (1213) 41 1/2" (1054)		
	WW1U1-7040	WW1U1-8040
61 11/16" (1567) 63 3/16" (1605) 60 1/2" (1537) 59 3/4" (1518) 53 1/2" (1359)		
	WW1U1-7050	WW1U1-8050

ELEVATION SYMBOL LEGEND:
M.O. = MASONRY OPENING
 VALUES IN () ARE IN MILLIMETER CONVERSIONS
 VALUES IN [] ARE NUMBER OF DAYLIGHT OPENINGS PER UNIT
E = BASIC UNIT CLEAR OPENING EXCEEDS 20" IN WIDTH, 24" IN HEIGHT & A MINIMUM OF 5.7 SQ. FT.

Note Elevations shown DO NOT have exterior trim. Subtract 3/4" (19) from M.O. (Masonry Opening) for Unit Sizes. Masonry Openings above include Sill Nose, see Trim Options page for Sill Nose specifications. For other Trim Options refer to the Unit Sizing, Rough Opening & Masonry Openings page.

SCALE: 1/8" = 1'

SASH GLAZING OPTIONS

INTERIOR GLAZING OPTIONS

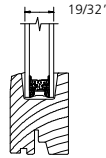

TRIM OPTIONS

EXTERIOR TRIM

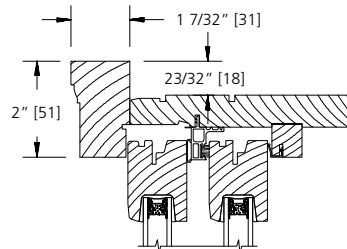

BRICKMOULD

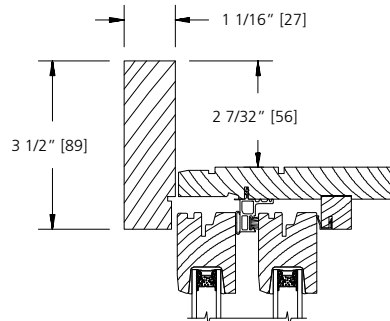

3 1/2" FLAT CASING

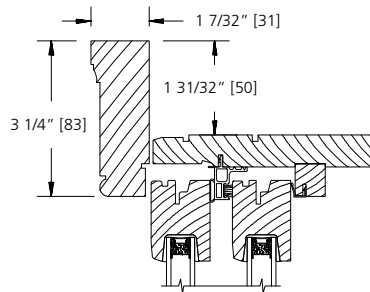

HERITAGE

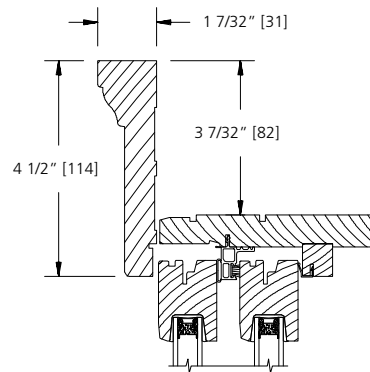

1 X 4 BACKBAND

SILL OPTION

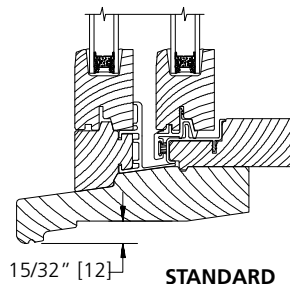

STANDARD

SCALE: 3" = 1'

JAMB EXTENDER OPTIONS

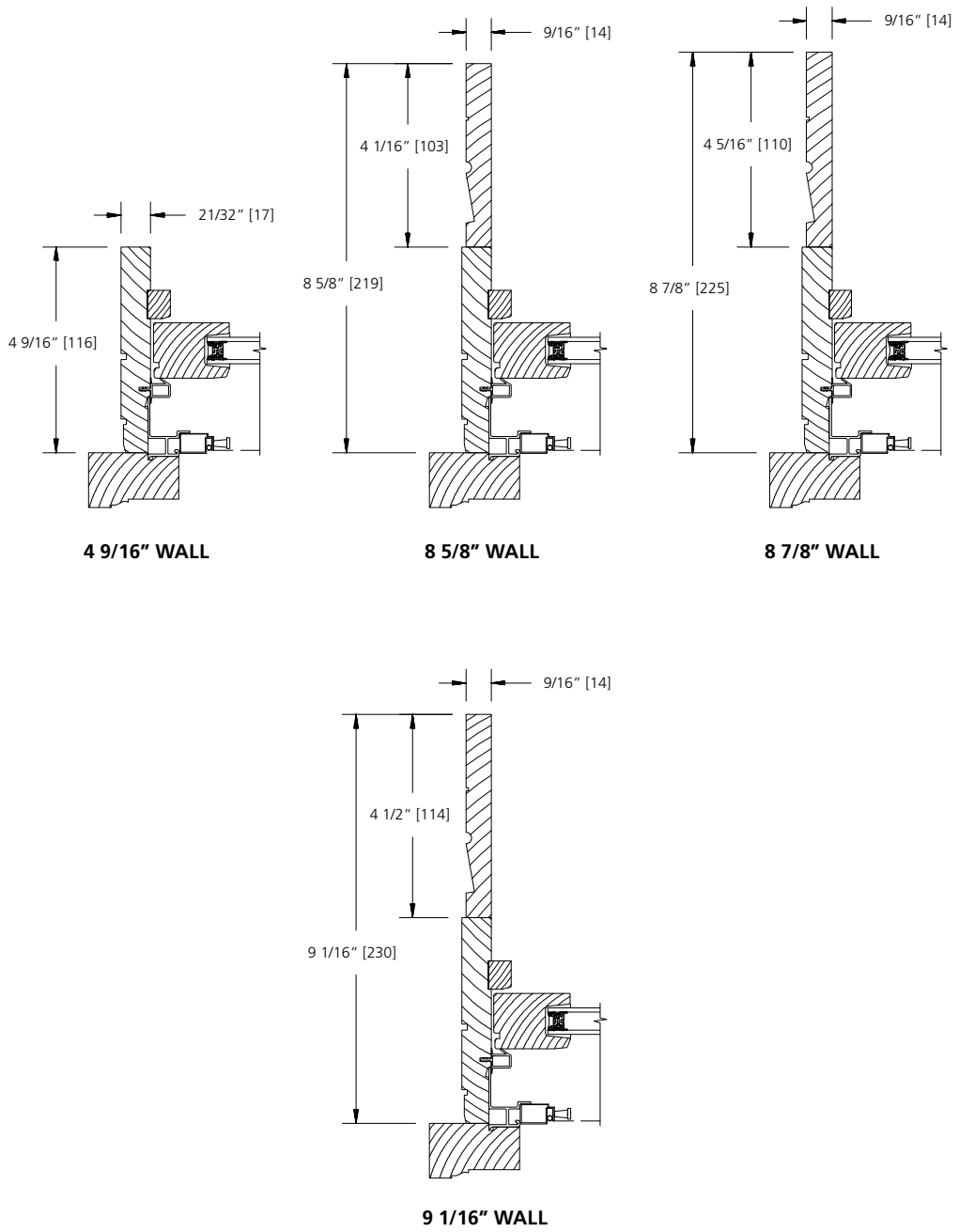

STANDARD MULLION OPTIONS

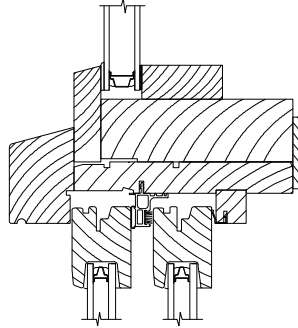

**DIRECT SET RADIUS
OVER HORIZONTAL SLIDER**

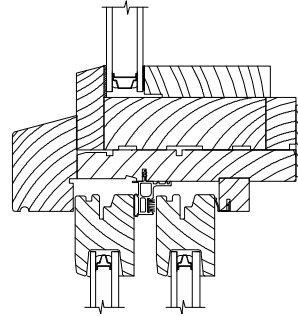

**DIRECT SET GEOMETRIC
OVER HORIZONTAL SLIDER**

LITE CUT INFORMATION

Wood horizontal sliding windows are available with removable grilles in 7/8", 1-1/8" and 1-3/8" widths, grilles between the glass (GBG), and Simulated Divided Lites. Standard lite cuts are rectangular.

LITE CUT OPTIONS

Special lite cut patterns can include a wide variety of straight line and radius patterns. The illustrations shown here represent just a few of the possibilities. Rectangular, horizontal, vertical and Prairie lite patterns are available in all standard size wood horizontal sliding windows. Uneven diamond, radius and Gothic lite cuts are available, subject to approval. Approvals are based on the ability to fulfill the design requirement while maintaining the construction integrity of the finished product.

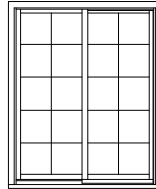

RECTANGULAR

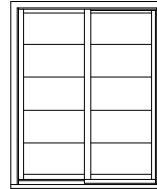

HORIZONTAL

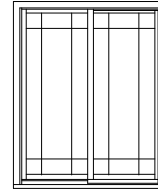

PRAIRIE

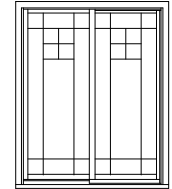

UNEVEN

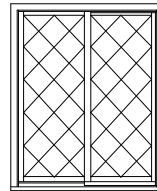

DIAMOND
SDL ONLY

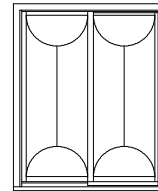

RADIUS

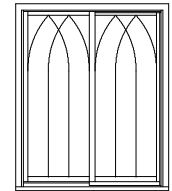

GOTHIC
SDL ONLY

BAR ALIGNMENT

Alignment of divided lite muntin bars from one window to the next is often required by fine architectural design. Wood grilles, GBG (Grilles between the Glass) and Simulated Divided Lites may be specified with muntin bars aligned.

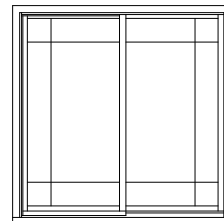
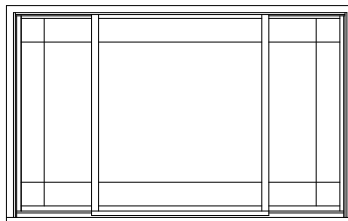
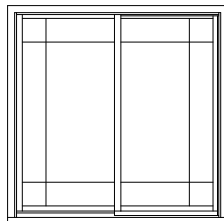

DIVIDED LITE OPTIONS

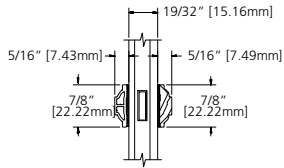

7/8" SDL

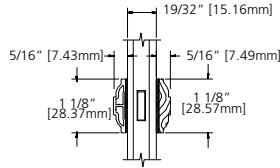

1 1/8" SDL

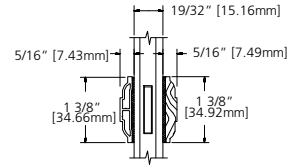

1 3/8" SDL

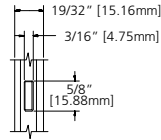

5/8" GRILLE

**UNIT SIZING, ROUGH OPENINGS
& MASONRY OPENINGS**

STANDARD OFFERING

BRICKMOULD AND SILLNOSE

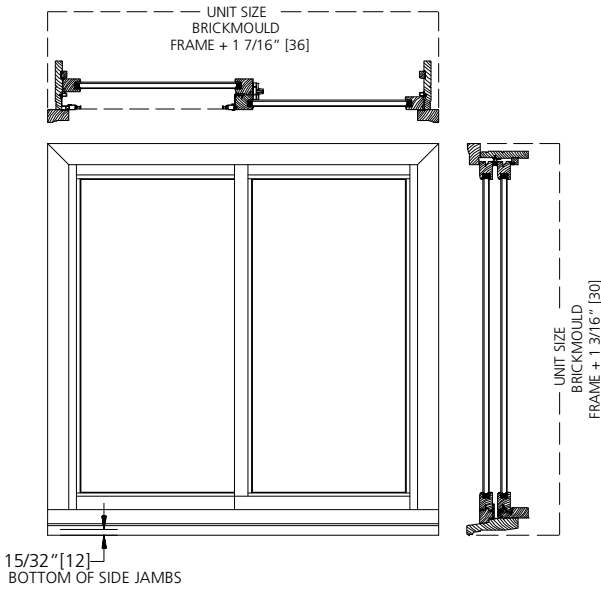

GENERAL NOTES:

UNIT SIZE IS ALWAYS THE
EXTREME SIZE OF THE WINDOW

MASONRY OPENING:
MASONRY OPENING IS ALWAYS 3/4" OVER
THE UNIT SIZE OF THE WINDOW

ROUGH OPENING:

ROUGH OPENING IS ALWAYS 3/4" OVER
FRAME SIZE OF THE WINDOW

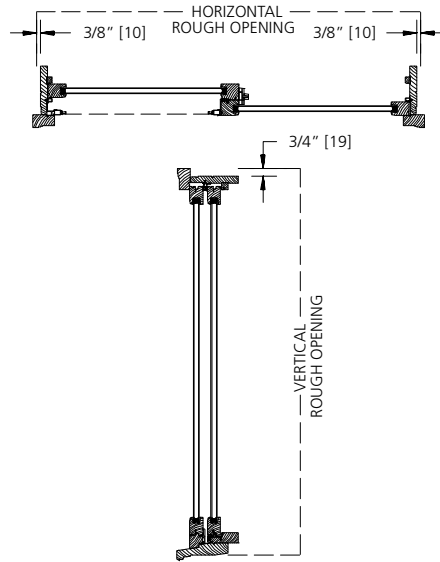

NON-STANDARD UNIT SIZING

EXTERIOR TRIM OFFERINGS WITH SILL NOSE
EXTERIOR TRIM MUST USE SILL NOSE

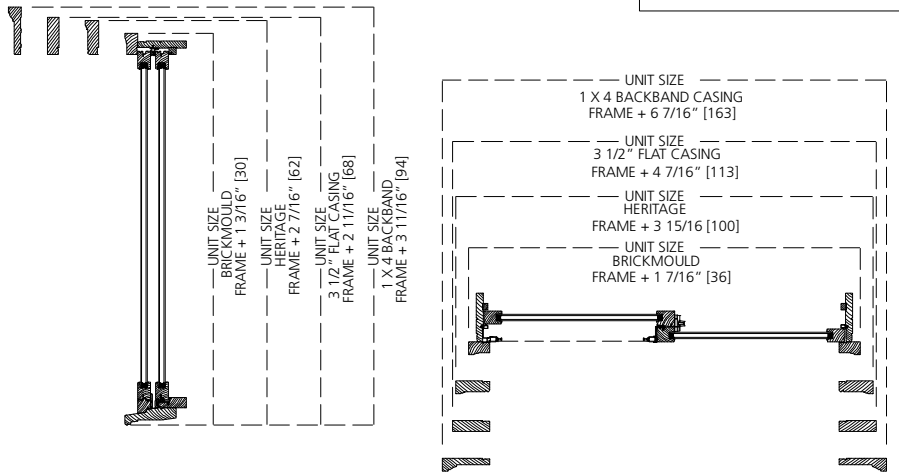

**FRAME TO TRIM
DIMENSIONS**

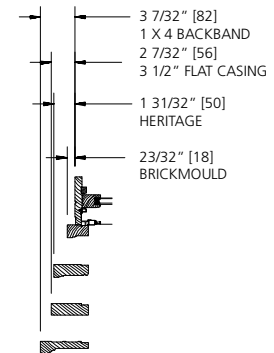

TYPICAL FOR HEAD & SIDES

SLIDING WINDOW

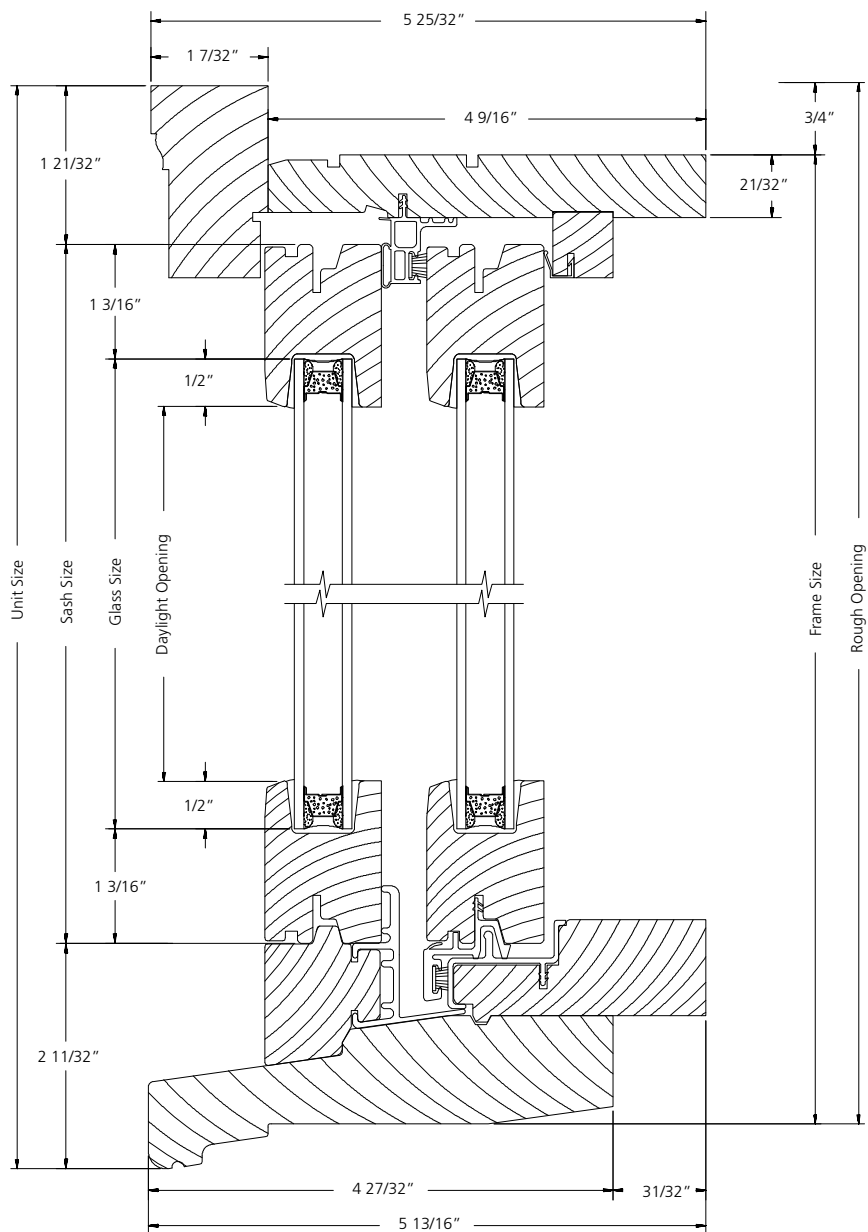

VERTICAL SECTION

SCALE: 6" = 1'

SLIDING WINDOW

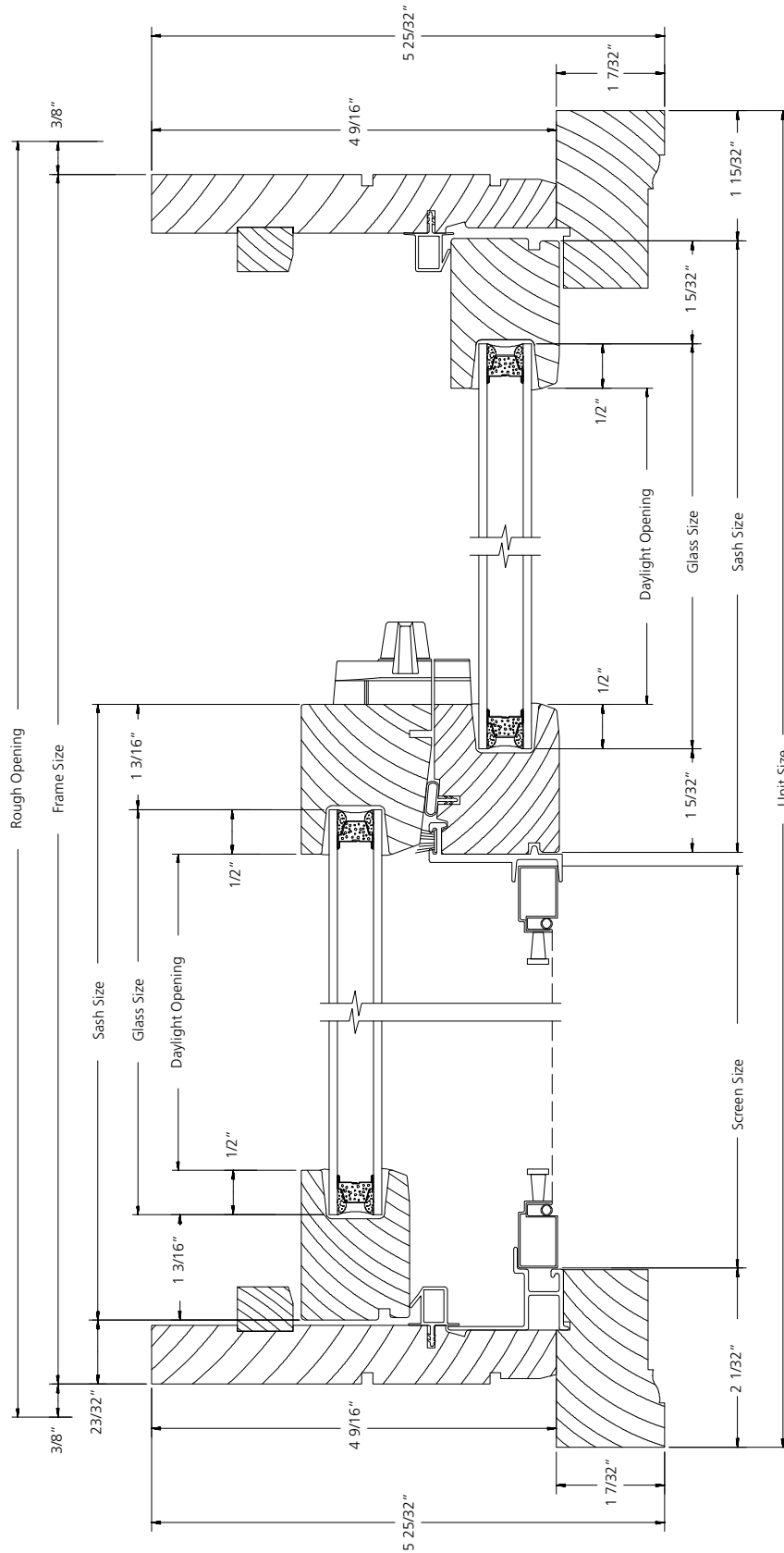

HORIZONTAL SECTION

SCALE: 6" = 1'

3-PANEL SLIDING WINDOW

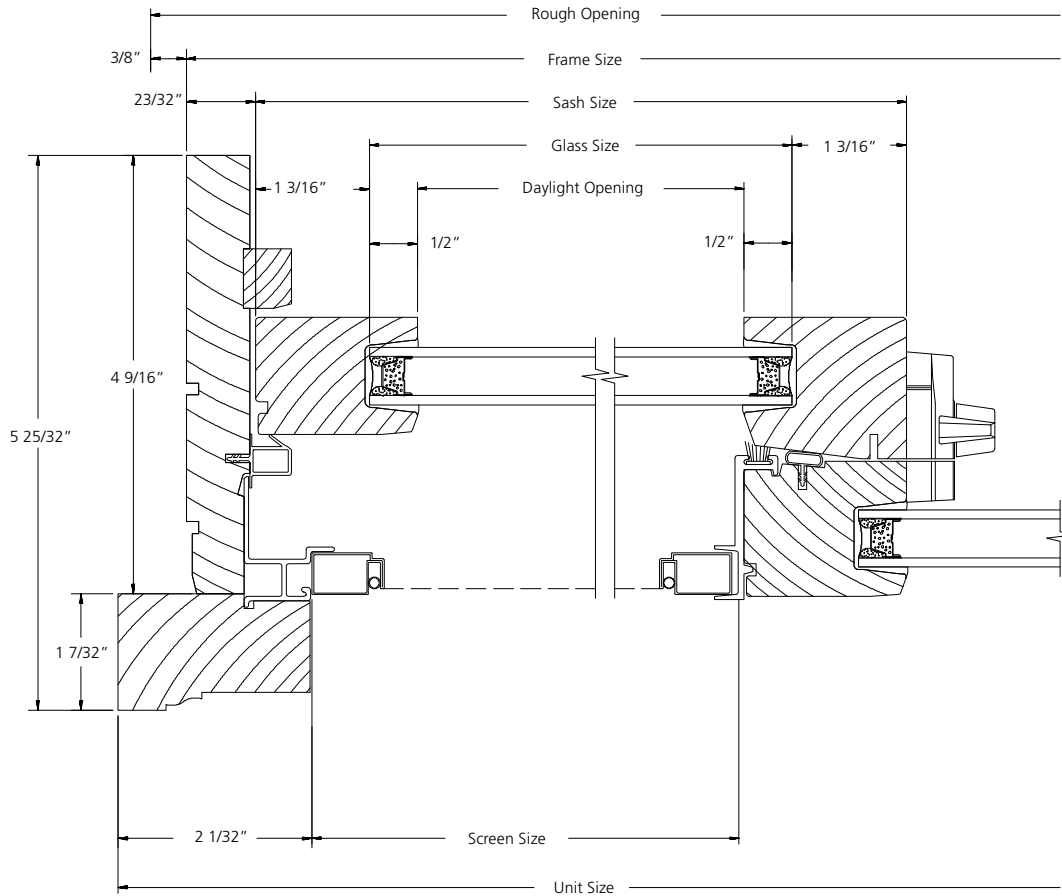

HORIZONTAL SECTION

SCALE: 6" = 1'