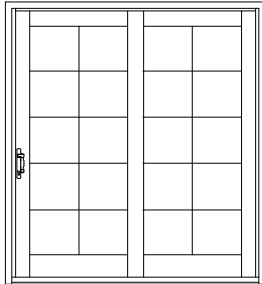

TABLE OF CONTENTS

| | |
|--|-------|
| Elevations/Sizes: 1/4" Scale | 18-2 |
| 2-Panel Doors | 18-4 |
| Bi-Parting (4-Panel) Doors | 18-5 |
| Glazing Options: 3" Scale | 18-7 |
| Trim Options: 3" Scale | 18-8 |
| Standard Mullion Options: 3" Scale | 18-9 |
| Lite Cut Information and Options | 18-10 |
| Unit Sizing, Rough Openings & Masonry Openings | 18-12 |
| Section Details: 6" Scale | 18-13 |

GENERAL INFORMATION



X o

DIMENSIONAL DOORS

Wood sliding patio doors may be specified as "dimensional" by adjusting the desired rough opening width or height in 1/8" increments from standard.

Wood sliding patio doors are available in single, twin, triple and quad panel doors. The standard size range includes sizes specifically designed for replacement of older patio door models in existing structures, as well as a full range of "true size" products for architectural consistency.

OPERATION

Wood sliding patio doors are available in a full range of operating and stationary styles. Single panel doors are only available as stationary (non-venting) styles. Two-panel doors are available with left or right operation. Three-panel doors are available with left and right operation and with center or end operators. Four-panel doors are available with two panels operating from the center. Configuration and handing is based on viewing the door from the exterior.

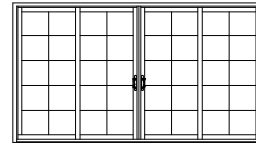
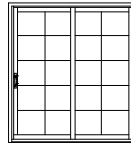

MULTIPLE ASSEMBLIES

Wood sliding patio doors are available in a variety of multiple panel configurations from the factory, all of which are assembled with continuous sills. Mulling of wood gliding patio doors to like products in the field is not recommended. Instead, individual factory assembled units should be installed in contiguous rough openings, in order to provide adequate framing support to assure the best performance of the door systems.

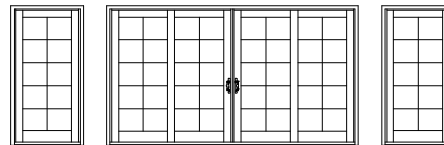
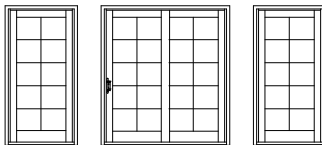

ELEVATION NOTES

ELEVATION DRAWINGS UTILIZE A LIMITED NUMBER OF PROJECTED LINES TO PRODUCE A RUDIMENTARY DRAWING INTENDED TO BE USED IN A SMALL GRAPHICAL SCALE. ELEVATIONS ARE VIEWED PERPENDICULAR FROM THE EXTERIOR OF THE STRUCTURE. IF MORE DIMENSIONS ARE NEEDED, USE THE SECTION DRAWINGS FOR MORE COMPLETE DEPICTIONS.

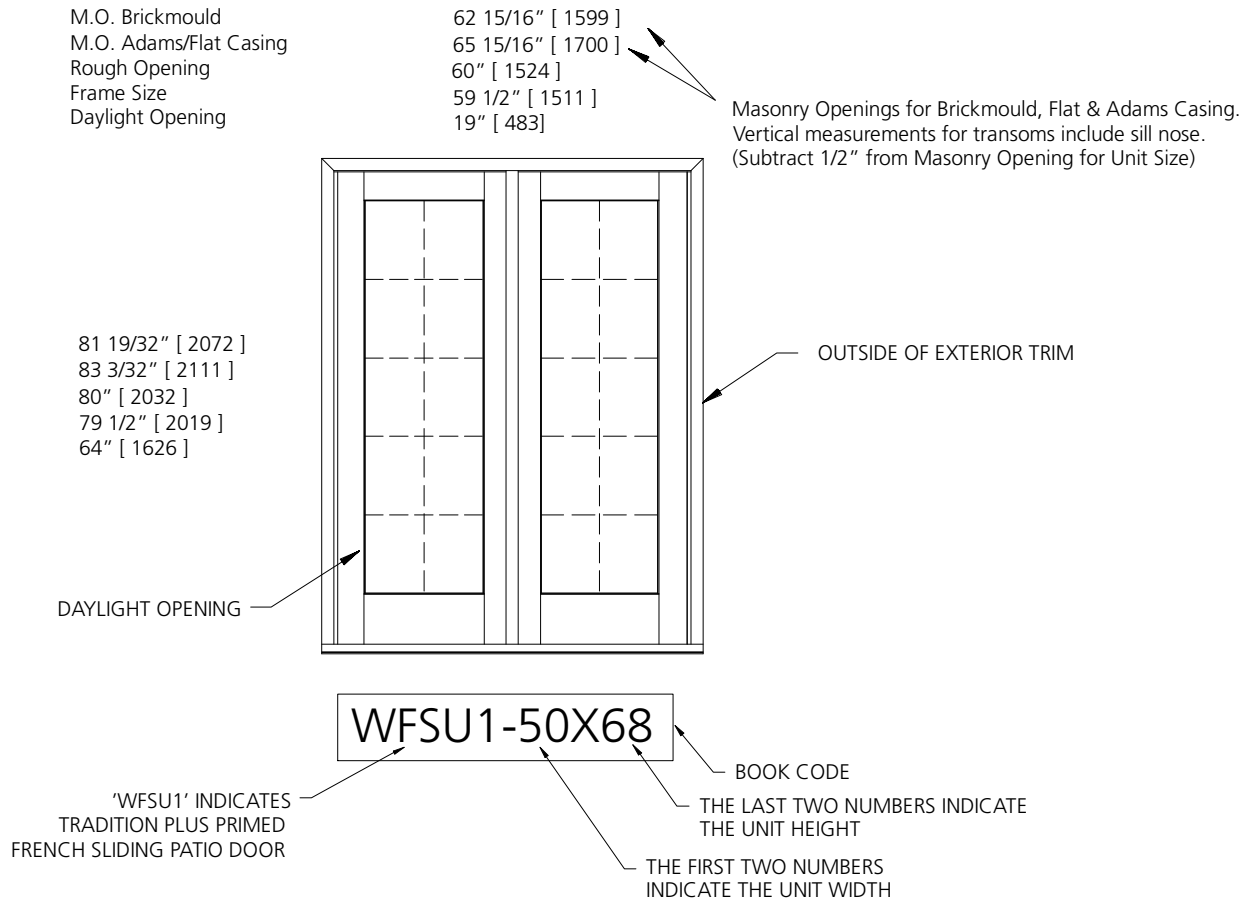

GENERAL SWINGING DOOR NOTES

1. TRADITION PLUS PRIME FRENCH SLIDING PATIO DOOR (WFSU1) UNITS ARE AVAILABLE AS OPERATING OR FIXED UNITS.
2. UNIT ELEVATIONS ARE SHOWN WITH BRICKMOULD. TRANSOM UNITS ARE SHOWN WITH BRICKMOULD AND SILL NOSE.
3. OPERATING UNITS ARE AVAILABLE AS LEFT OR RIGHT HAND OPERATION.

ELEVATION SYMBOL LEGEND

M.O. MASONRY OPENING

2-PANEL DOORS

M.O. BRICKMOULD
M.O. ADAMS/FLAT CASING
ROUGH OPENING
FRAME SIZE
DAYLIGHT OPENING

62 15/16" (1599)
65 15/16" (1700)
60" (1524)
59 1/2" (1511)
19" (483)[2]

74 15/16" (1903)
77 15/16" (1979)
72" (1829)
71 1/2" (1816)
25" (635)[2]

98 15/16" (2513)
101 15/16" (2588)
96" (2438)
95 1/2" (2426)
37" (940)[2]

81 19/32" (2072)
83 3/32" (2111)
80" (2032)
79 1/2" (2019)
64" (1626)

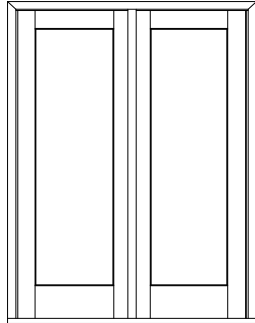

WFSU1-50X68

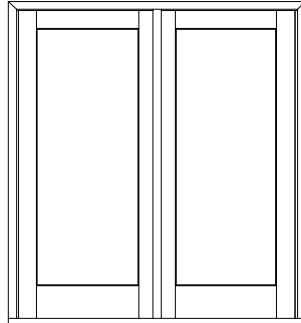

WFSU1-60X68

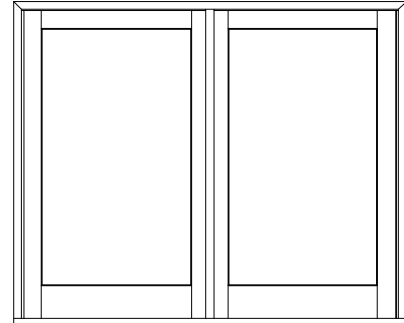

WFSU1-80X68

84 19/32" (2149)
86 3/32" (2187)
83" (2108)
82 1/2" (2096)
67" (1702)

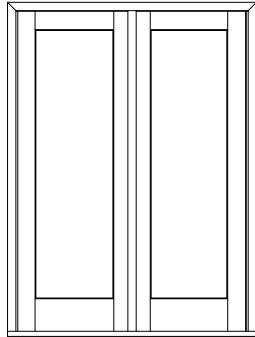

WFSU1-50X68

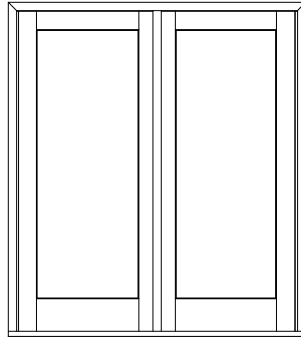

WFSU1-60X68

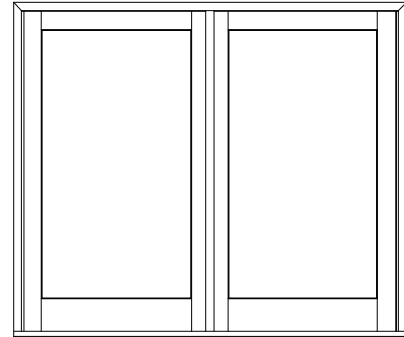

WFSU1-80X68

97 19/32" (2479)
99 3/32" (2517)
96" (2438)
95 1/2" (2426)
80" (2032)

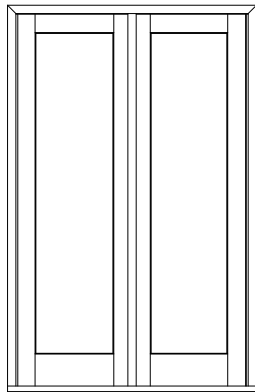

WFSU1-50X80

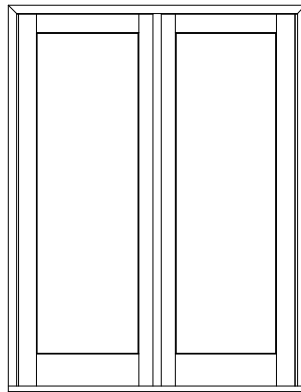

WFSU1-60X80

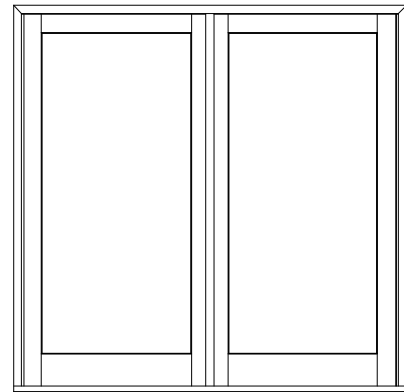

WFSU1-80X80

ELEVATION SYMBOL LEGEND:
M.O. = MASONRY OPENING
VALUES IN () ARE IN MILLIMETER CONVERSIONS

Note Elevations shown DO NOT have exterior trim. Subtract 3/4" (19) from M.O. (Masonry Opening) for Unit Sizes. Masonry Openings above include Sill Nose, see Trim Options page for Sill Nose specifications. For other Trim Options refer to the Unit Sizing, Rough Opening & Masonry Openings page.

SCALE: 1/4" = 1'

BI-PARTING (4-PANEL) DOORS

M.O. BRICKMOULD
M.O. ADAMS/FLAT CASING
ROUGH OPENING
FRAME SIZE
DAYLIGHT OPENING

121 7/16" (3085)
124 7/16" (3161)
118 1/2" (3010)
118" (2997)
19" (483)[4]

145 7/16" (3694)
148 7/16" (3770)
142 1/2" (3620)
142" (3607)
25" (635)[4]

81 19/32" (2072)
83 3/32" (2111)
80" (2032)
79 1/2" (2019)
64" (1626)

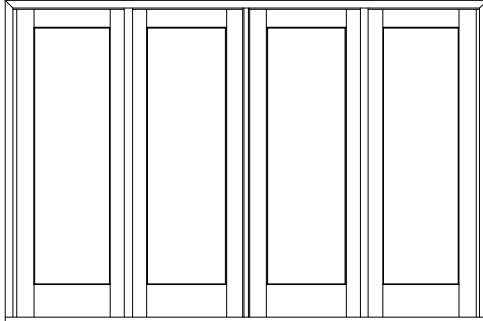

WFBU1-100X68

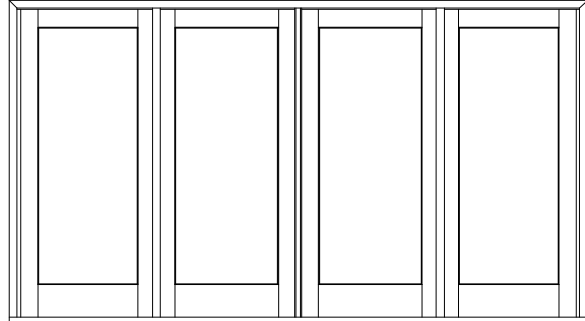

WFBU1-120X68

84 19/32" (2149)
86 3/32" (2187)
83" (2108)
82 1/2" (2096)
67" (1702)

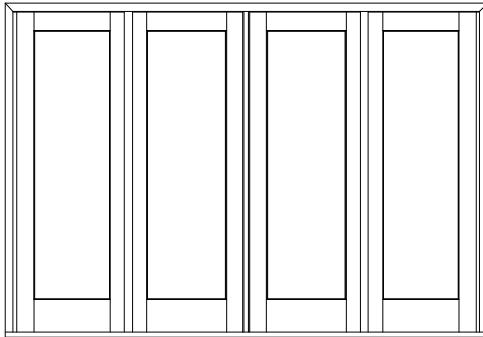

WFBU1-100X68

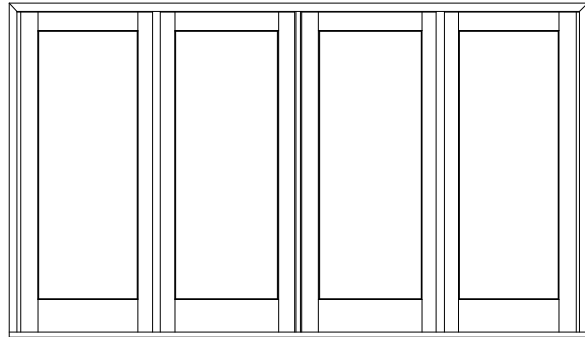

WFBU1-120X68

97 19/32" (2479)
99 3/32" (2517)
96" (2438)
95 1/2" (2426)
80" (2032)

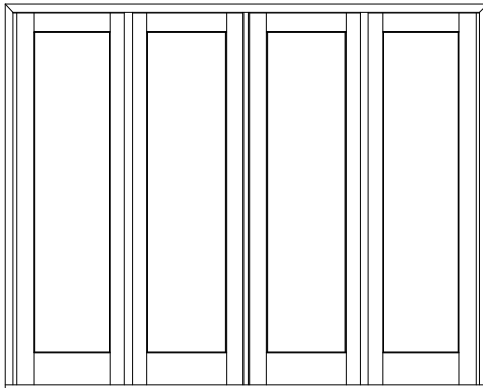

WFBU1-100X80

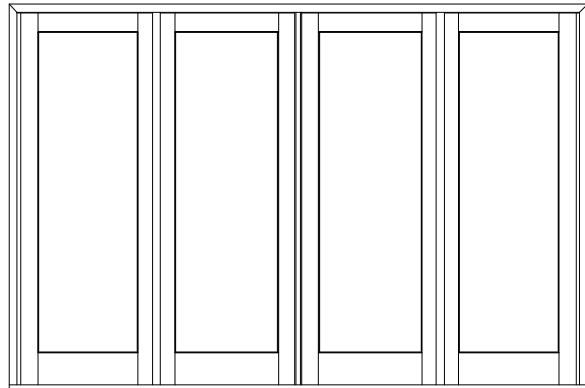

WFBU1-120X80

ELEVATION SYMBOL LEGEND:

M.O. = MASONRY OPENING
VALUES IN () ARE IN MILLIMETER CONVERSIONS
VALUES IN [] ARE NUMBER OF DAYLIGHT OPENINGS PER UNIT

Note Elevations shown DO NOT have exterior trim. Subtract 3/4" (19) from M.O. (Masonry Opening) for Unit Sizes. Masonry Openings above include Sill Nose, see Trim Options page for Sill Nose specifications. For other Trim Options refer to the Unit Sizing, Rough Opening & Masonry Openings page.

SCALE: 1/4" = 1'

BI-PARTING (4-PANEL) DOORS

M.O. BRICKMOULD
M.O. ADAMS/FLAT CASING
ROUGH OPENING
FRAME SIZE
DAYLIGHT OPENING

193 7/16" (4913)
196 7/16" (4990)
190 1/2" (4839)
190" (4826)
37" (940) [4]

81 19/32" (2072)
83 3/32" (2111)
80" (2032)
79 1/2" (2019)
64" (1626)

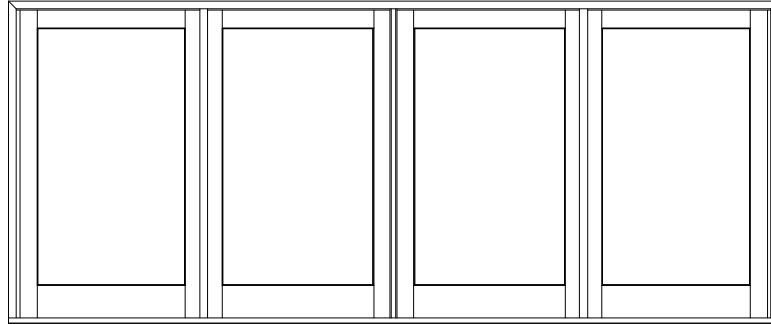

WFBU1-160X68

84 19/32" (2149)
86 3/32" (2187)
83" (2108)
82 1/2" (2096)
67" (1702)

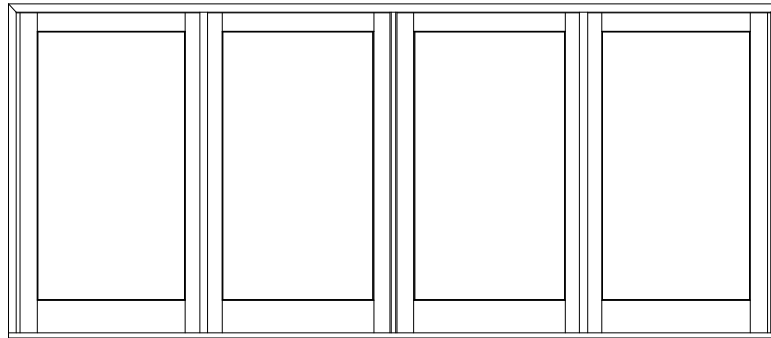

WFBU1-160X6B

97 19/32" (2479)
99 3/32" (2517)
96" (2438)
95 1/2" (2426)
80" (2032)

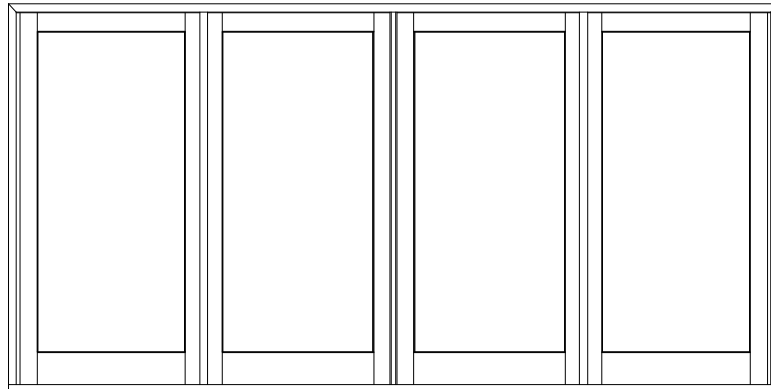

WFBU1-160X80

ELEVATION SYMBOL LEGEND:

M.O. = MASONRY OPENING
VALUES IN () ARE IN MILLIMETER CONVERSIONS
VALUES IN [] ARE NUMBER OF DAYLIGHT OPENINGS PER UNIT

Note Elevations shown DO NOT have exterior trim. Subtract 3/4" (19) from M.O. (Masonry Opening) for Unit Sizes. Masonry Openings above include Sill Nose, see Trim Options page for Sill Nose specifications. For other Trim Options refer to the Unit Sizing, Rough Opening & Masonry Openings page.

SCALE: 1/4" = 1'

GLAZING OPTIONS

INTERIOR GLAZED

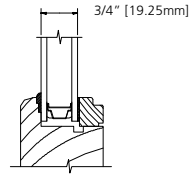

INSULATED GLASS

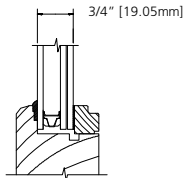

**LAMINATED INSULATED
CLEAR OR LOW-E**
3.0mm//6.7mm LAMINATE

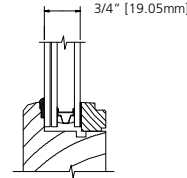

**LAMINATED INSULATED
TINTED**
6.7mm LAMINATE//3.0mm

TRIM OPTIONS

EXTERIOR TRIM

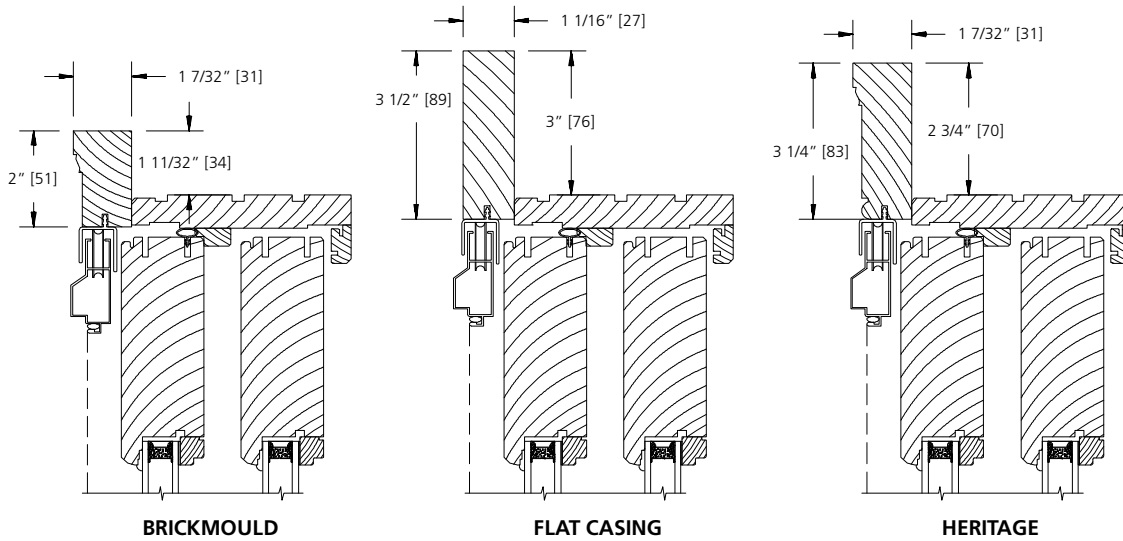

WOOD SUBSILL OPTIONS

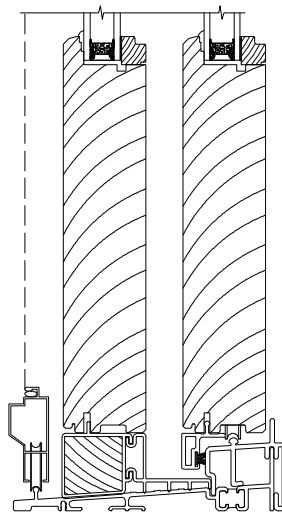

STANDARD

SCALE: 3" = 1'

STANDARD MULLION OPTIONS

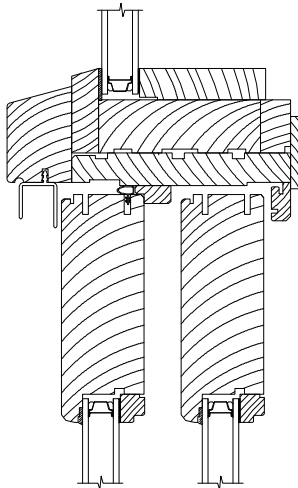

**DIRECT SET GEOMETRIC
FRENCH VIEW SLIDER**

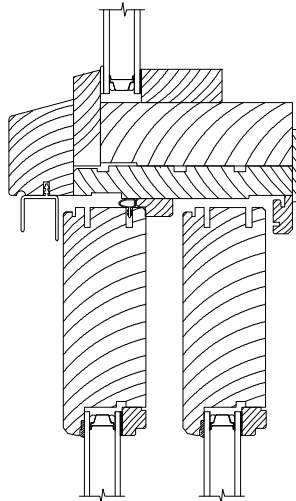

**DIRECT SET OVER
FRENCH VIEW SLIDER**

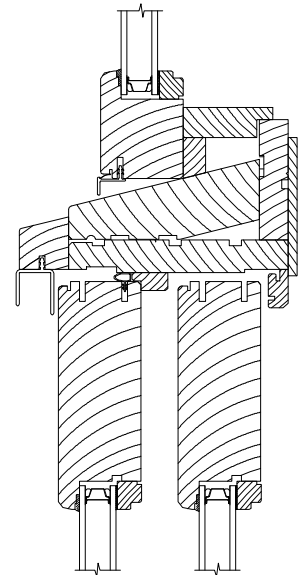

**FRENCH VIEW TRANSOM OVER
FRENCH VIEW SLIDER**

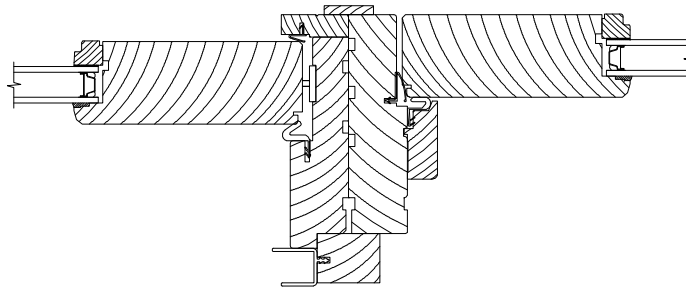

**FRENCH VIEW SLIDER NEXT TO
FRENCH VIEW INSWING SIDELIGHT**

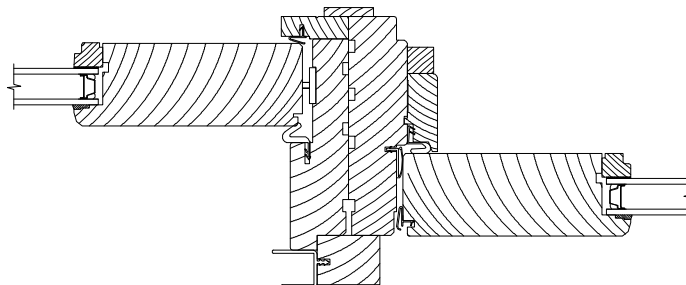

**FRENCH VIEW SLIDER NEXT TO
FRENCH VIEW OUTSWING SIDELIGHT**

SCALE: 3" = 1'

LITE CUT INFORMATION

Wood Sliding patio doors are available with removable grilles in 7/8", 1-1/8" and 1-3/8" widths, with grilles between the glass (GBG), or with Simulated Divided Lites. Standard lite cuts are rectangular.

LITE CUT OPTIONS

Special lite cut patterns can include a wide variety of straight line and radius patterns. The illustrations shown here represent just a few of the possibilities. Rectangular, horizontal, vertical and Prairie lite patterns are available in all standard size Wood Sliding patio doors. Uneven, diamond, radius and Gothic lite cuts are available, subject to approval. Approvals are based on the ability to fulfill the design requirement while maintaining the construction integrity of the finished product.

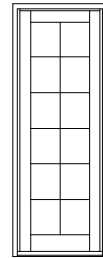

RECTANGULAR

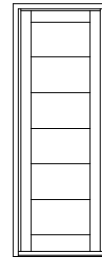

HORIZONTAL

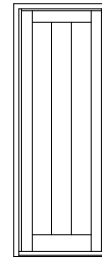

VERTICAL

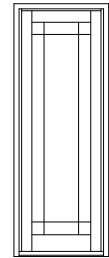

PRAIRIE



UNEVEN

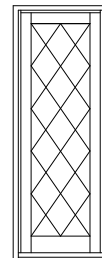

DIAMOND

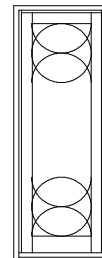

RADIUS

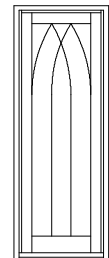

GOthic

BAR ALIGNMENT

Alignment of divided lite muntin bars from one product to the next is often required by fine architectural design. Wood grilles, GBG's, and Simulated Divided Lites may be specified with muntin bars aligned.

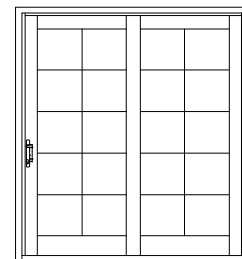
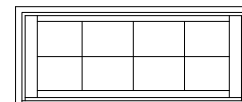

DIVIDED LITE OPTIONS

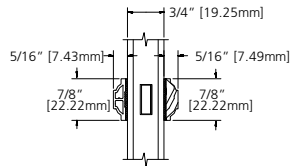

7/8" SDL

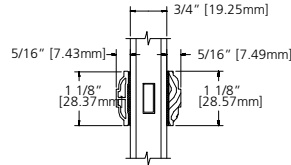

1 1/8" SDL

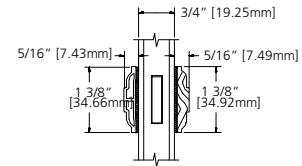

1 3/8" SDL

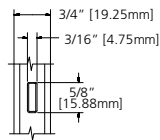

5/8" GRILLE

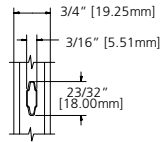

23/32" GRILLE

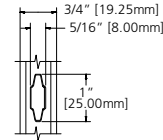

1" GRILLE

CLEAR OPENING INFORMATION

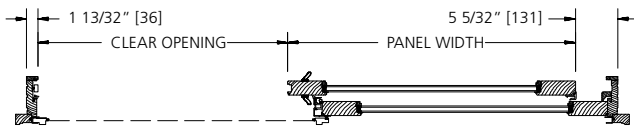

HORIZONTAL
Two Panel Assembly

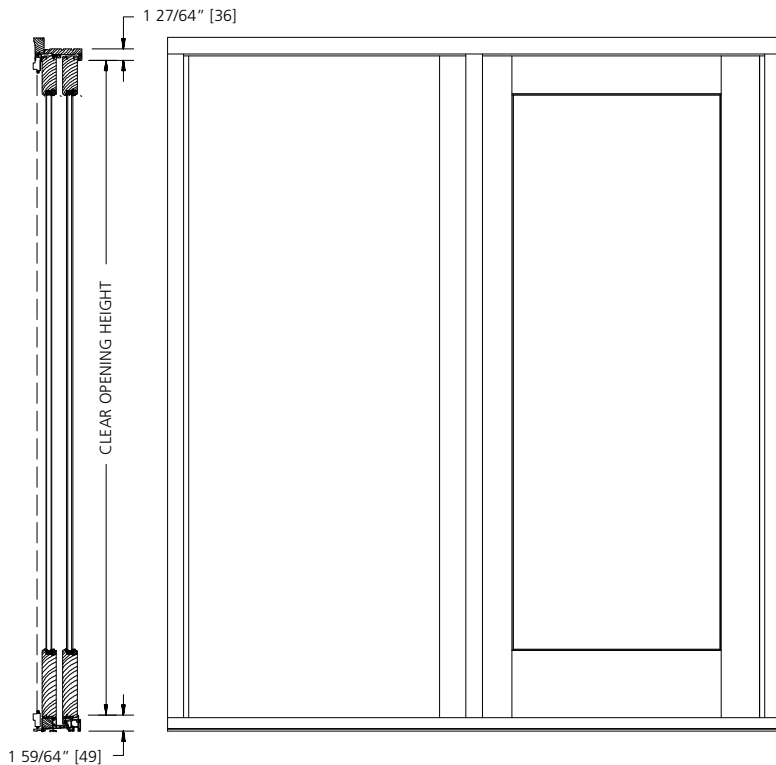

Clear Opening Formulas

Horizontal

Frame - (Panel Width + 6 9/16") = Clear Opening

Vertical

Frame - 3 11/32" = Clear Opening

HORIZONTAL
Four Panel Assembly

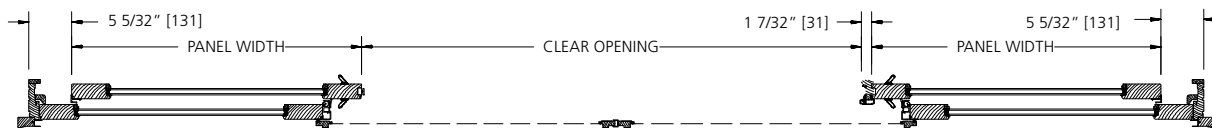

Clear Opening Formulas

Horizontal

Frame - ((2 x (Panel Width + 5 5/32")) + 1 7/32") = Clear Opening

Vertical

Frame - 3 11/32" = Clear Opening

**UNIT SIZING, ROUGH OPENINGS
& MASONRY OPENINGS**

STANDARD OFFERING

BRICKMOULD

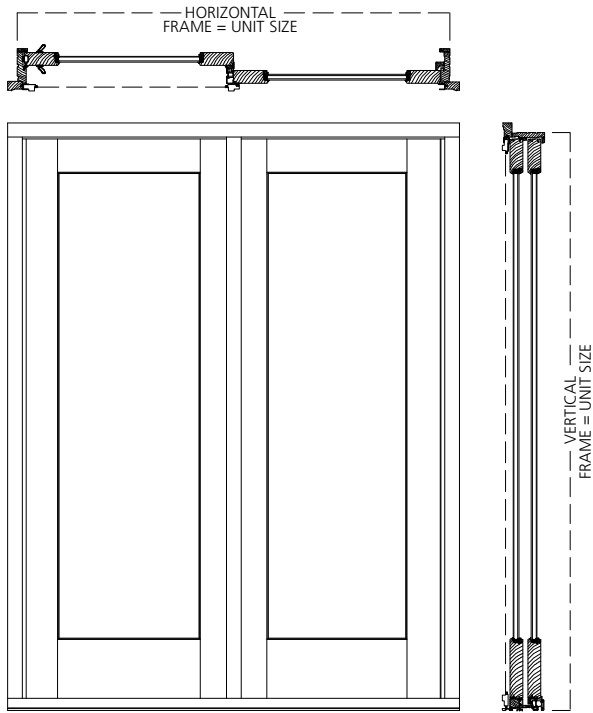

GENERAL NOTES:

UNITS WITH NO EXTERIOR TRIM
FRAME SIZE = UNIT SIZE

UNIT SIZE IS ALWAYS THE
EXTREME SIZE OF THE DOOR
WITH OR WITHOUT TRIM

ROUGH OPENING IS ALWAYS 3/4" OVER
FRAME SIZE OF THE DOOR

MASONRY OPENING IS ALWAYS 1/2"
OVER THE UNIT SIZE OF THE DOOR

ROUGH OPENING:

BRICKMOULD



UNIT SIZE

FRAME TO EXTERIOR TRIM (UNIT) SIZE

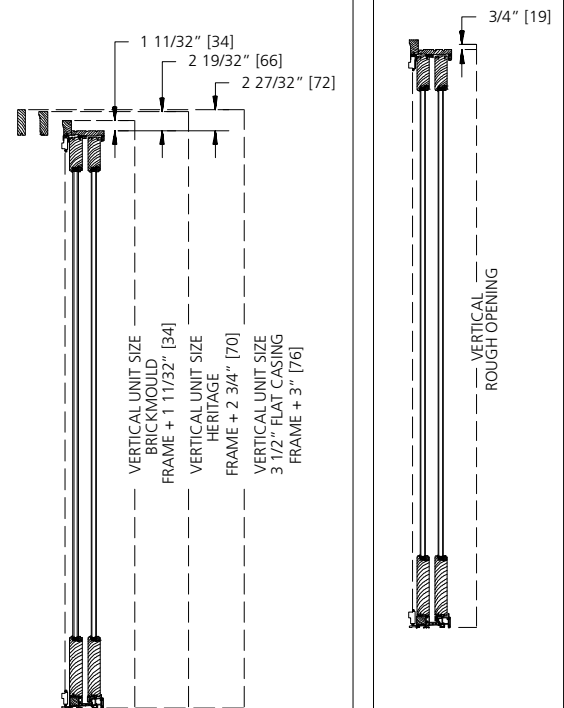
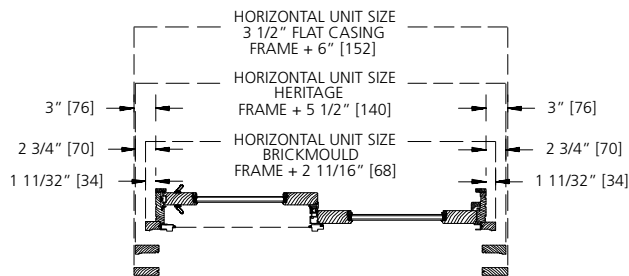

SLIDING PATIO DOOR

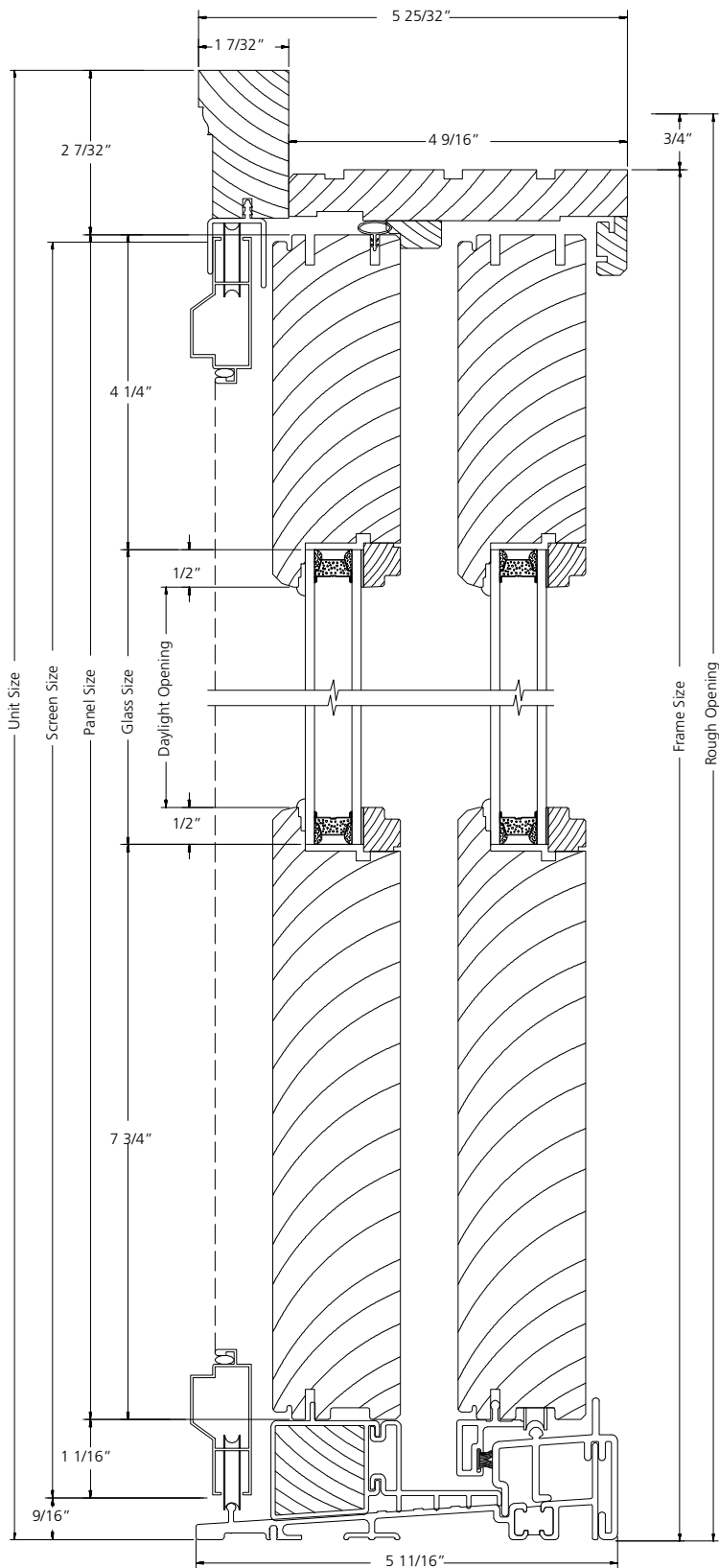

VERTICAL SECTION

SCALE: 3" = 1'

2-PANEL DOOR

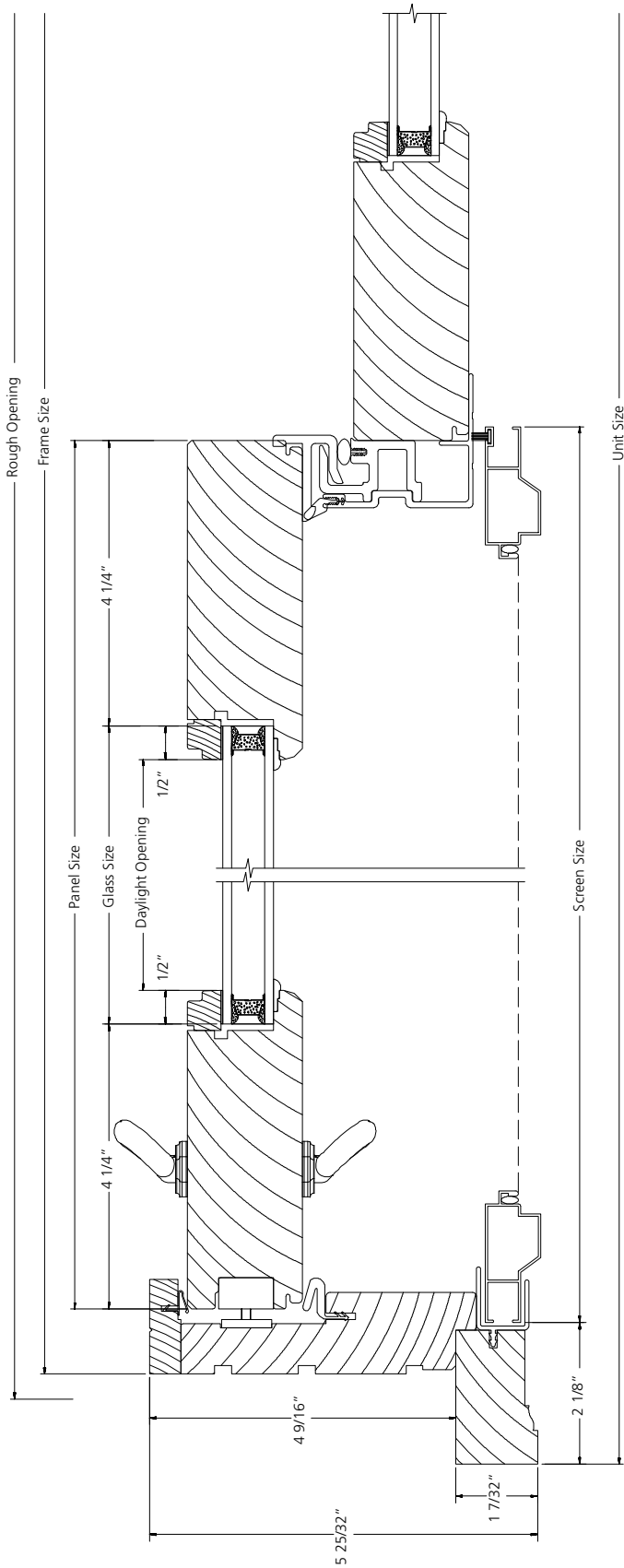

HORIZONTAL SECTION

BI-PARTING (4-PANEL) DOOR

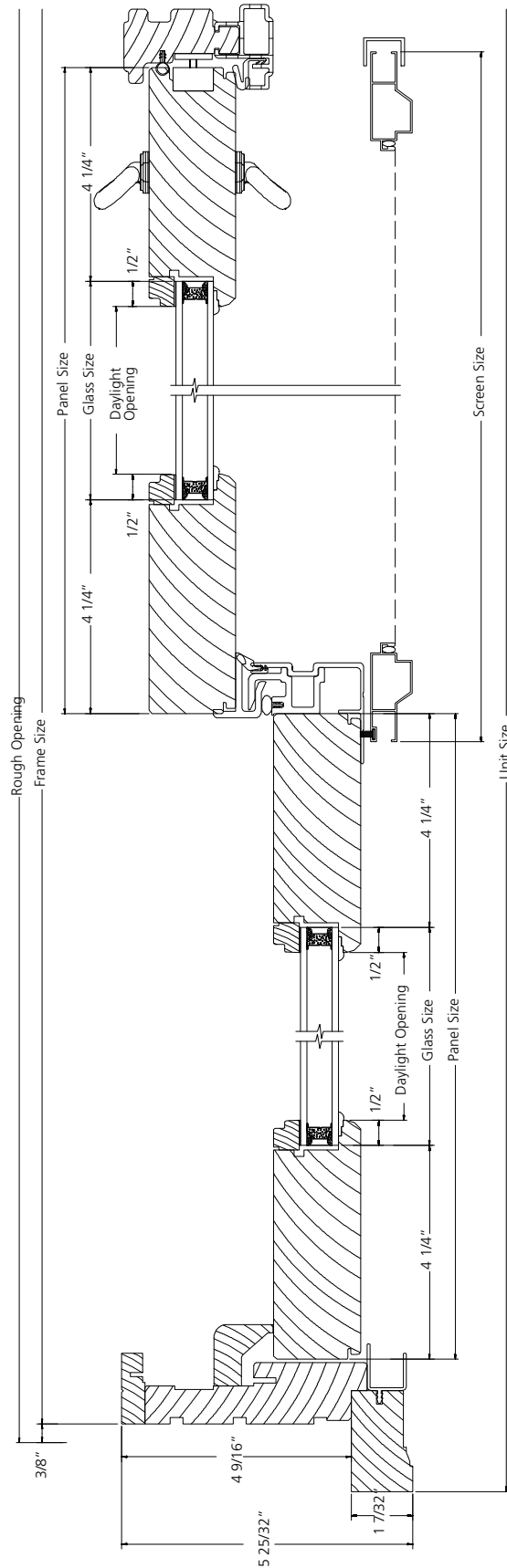

HORIZONTAL SECTION